



GERMAN  
DESIGN  
AWARD  
GOLD  
2023

# ***Omnia L***

THE BEST OPTION  
ON THE MARKET



FORMENTI &  
GIOVENZANA



OPENING



CARLO  
CASAGRANDE & CO

Changing spaces into special places

FORMENTI & GIOVENZANA PROVIDES  
FUNCTIONAL SOLUTIONS FOR  
FURNITURE TO MEET THE REAL NEEDS  
OF A LARGE NUMBER OF CUSTOMERS.

---

All products are conceived and supplied with care and quality and are offered to the market at a competitive price. In this way, Formenti & Giovenzana contributes globally to increase the satisfaction of the customers buying furniture, giving access to pleasing features and improving the quality of life of the consumers.

# Content

---

02 – INTRO

06 – REASONS TO CHOOSE OMNIA L

10 – OMNIA L 105°

12 – OMNIA L 105° FOR CORNER DOORS

14 – OMNIA L 155°

16 – MOUNTING PLATES

17 – ACCESSORIES

# Omnia L

SLOWMOTION TECHNOLOGY INSIDE  
IMPROVED MODERN DESIGN  
STRENGTH AND HIGH  
PERFORMANCES  
EASY CLICK FIXING SYSTEM

The Omnia L hinge, from old latin language: omnia, omnium. represents the perfect synthesis of all the best features.

All the best as concern the technical know-how.

All the must-have features for a premium hinge.

All the FGV experience developed in 70 years on the Market.

All that a Customer can get from an hinge.

Omnia L is really the best option on the market!



# Reasons to choose Omnia L

## OMNIA L HINGE RANGE

The Omnia L SlowMotion hinge is the new top product of the FGV's offer originates from the research and the experience built up in over 70 years of presence in the field. Equipped with a state-of-the-art Linear SlowMotion Technology, it ensures stable and constant operation in all conditions of use. Produced in Italy it boosts all the best features and performances required by the market of damped systems.

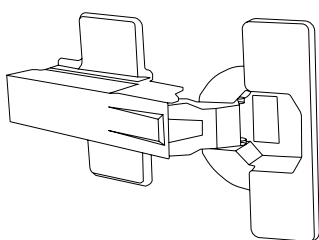

## NEVER SO EASY TO HANG A DOOR!

No limits to door dimensions and to hinge numbers. AnyClickSystem an intelligent and practical solution to fit the hinges in any position without any stress. A really fantastic simplification for the wardrobe doors.

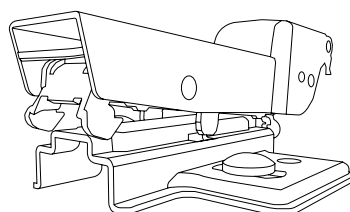



## ALL THE BENEFITS FROM THE LINEAR SLOWMOTION

State-of-the-art Linear SlowMotion Technology, for a perfect damped closure in every condition, based on stable shock absorber at all high and low temperatures, adaptive controlled movement without manual adjustments, 25° of smooth braking to avoid door rebound.

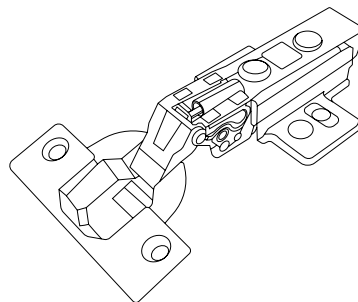

## A TECHNOLOGY TO COVER EVERY APPLICATION

Full range of cranks and angle solutions; full choice of fixing systems, included the Velofix version. Range of reversible mounting plates with 3D independent adjustment: fast, simple, precise and intuitive.

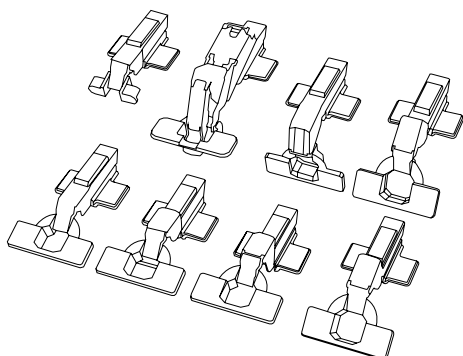

# Omnia L

## PERFORMANCE

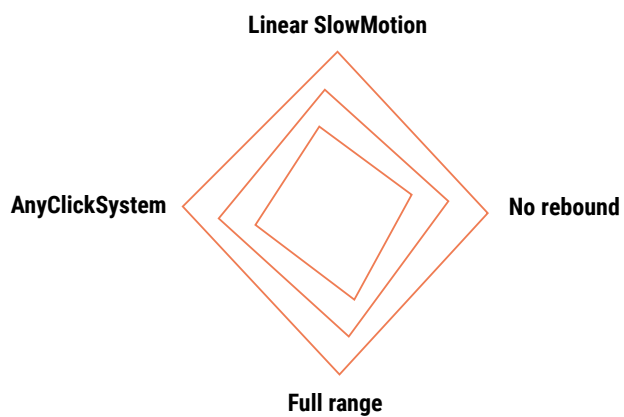

Linear SlowMotion Damper hidden into the hinge arm

Modern and elegant design patented

Box and Arm cover caps

Mounting Plate



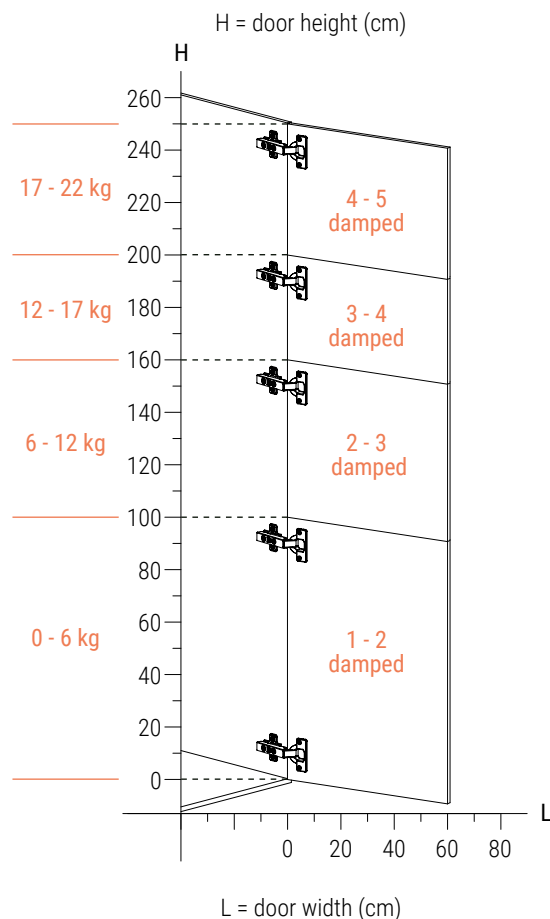

## ANYCLICKSYSTEM



For an easy and quick fitting in any position.



## ADJUSTING SYSTEM



### Depth adjustment

Acting on the "A" screw  
it is possible to adjust the distance between  
the side of the cabinet and the door.



### Independent side adjustment

Acting on the "B" screw  
it is possible to change the amount of the  
door covering on the side of the cabinet.



### Vertical adjustment

Acting on the "C" screw  
of the mounting plate it is possible to adjust  
the door vertically.



## Technical Specifications:

- Depth of the metal cup 11.4 mm
- Cup diameter 35 mm
- Opening 105°
- Possibility of door drilling (K) from 3 to 7 mm
- Thickness of the door (T) from 14 to 26 mm



LINEAR  
DAMPER

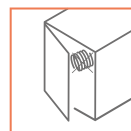

NO REBOUND



ANYCLICK  
SYSTEM

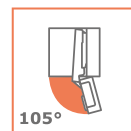

105°  
OPENING



X-PANDO EXPANDING DOWEL

A45

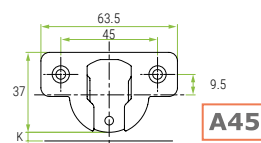

CUP HOLE DISTANCE 45X9.5 MM

A45

## with SlowMotion

### CRANK 0



Code	Description	PG
51LSX8M900AX000	OMNIA L 105 C0 SLOWMO.HINGE X-P	0126
51LSX8M200AX000	OMNIA L 105 C0 SLOWMO.HINGE X-P BLACK	0127

### CRANK 8



Code	Description	PG
51LSX8M908AX000	OMNIA L 105 C8 SLOWMO.HINGE X-P	0126
51LSX8M208AX000	OMNIA L 105 C8 SLOWMO.HINGE X-P BLACK	0127

### CRANK 15



Code	Description	PG
51LSX8M915AX000	OMNIA L 105 C15 SLOWMO.HINGE X-P	0126
51LSX8M215AX000	OMNIA L 105 C15 SLOWMO.HINGE X-P BLACK	0127

## without SlowMotion

Code	Description	PG
51LSX8M900A000	OMNIA L 105 C0 HINGE X-P	0128
51LSX8M908A000	OMNIA L 105 C8 HINGE X-P	0128
51LSX8M915A000	OMNIA L 105 C15 HINGE X-P	0128

### CRANK 0 For lay-on doors

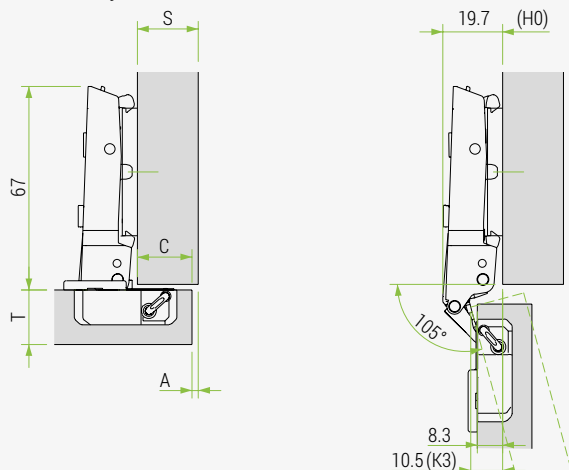

H*		Drilling distance (k)				
		3	4	5	6	7
Overlay (C) Crank 0	19				0	
	18			0		2
	17		0		2	
	16	0		2		4
	15		2		4	
	14	2		4		6
	13		4		6	
	12	4		6		
	11		6			
	10	6				

\* = with H between two values get the lower one

### CRANK 8 For partial lay-on doors

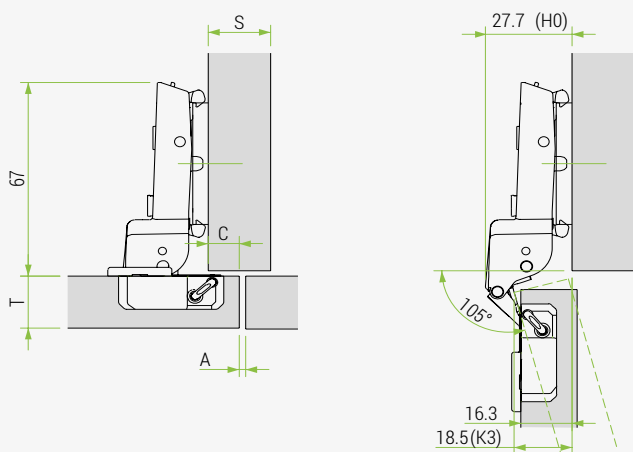

H*		Drilling distance (k)				
		3	4	5	6	7
Overlay (C) Crank 8	11				0	
	10			0		2
	9		0		2	
	8	0		2		4
	7		2		4	
	6	2		4		6
	5		4		6	
	4	4		6		
	3		6			
	2	6				

\* = with H between two values get the lower one

### CRANK 15 For inset doors

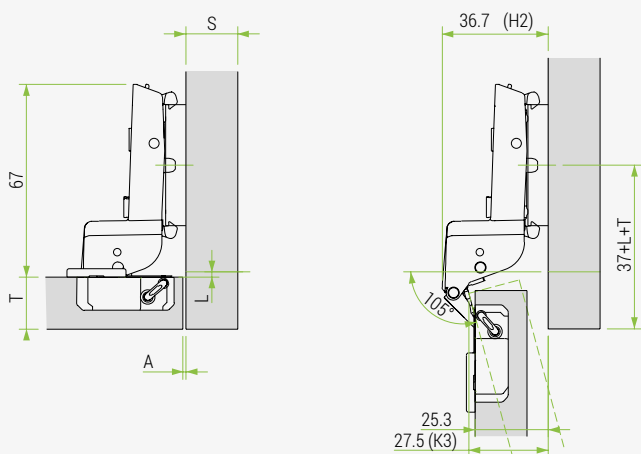

H*		Drilling distance (k)				
		3	4	5	6	7
Overlay (C) Crank 15	1	0		2		4
	0		2		4	
	-1	2		4		6
	-2		4		6	
	-3	4		6		
	-4		6			
	-5					
	-6					
	-7					
	-8					

\* = with H between two values get the lower one

Table to determinate the minimum distance A so that a door with T thickness can open without protrusion from the cabinet and without interfering with adjacent doors.

	T=	14	15	16	17	18	19	20	21	22	23	24	25	26
K=3	A=	0.1	0.2	0.3	0.4	0.5	0.7	0.8	1	1.2	2	3.2	4.5	5.8
K=4	A=	0.1	0.2	0.3	0.4	0.5	0.6	0.8	1	1.2	1.4	2.2	3.5	4.9
K=5	A=	0.1	0.2	0.3	0.3	0.5	0.6	0.8	1	1.2	1.4	1.6	2.5	3.8
K=6	A=	0.1	0.2	0.3	0.3	0.5	0.6	0.8	1	1.2	1.4	1.6	1.9	2.8
K=7	A=	0.1	0.2	0.3	0.3	0.5	0.6	0.8	1	1.2	1.4	1.6	1.9	2.8

Omnia L 105° for corner doors



Technical Specifications:

- Depth of the metal cup 11.4 mm
- Cup diameter 35 mm
- Opening 105°
- Possibility of door drilling (K) from 3 to 7 mm
- Thickness of the door (T) from 14 to 26 mm



LINEAR  
DAMPER

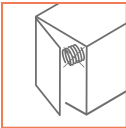

NO REBOUND

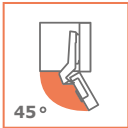

OPENING



OPENING



ANYCLICK  
SYSTEM

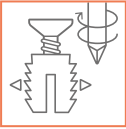

X-PANDO EXPANDING DOWEL

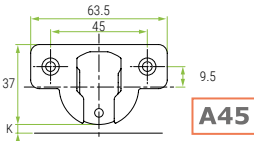

CUP HOLE DISTANCE 45X9.5 MMM

ANGLE 45°



Code	Description	PG
51LSX8M945AX000	OMNIA L 45 SLOWMO.HINGE X-P	0126
51LSX8M245AX000	OMNIA L 45 SLOWMO.HINGE X-P BLACK	0127

ANGLE 90°



Code	Description	PG
51LSX8M990AX000	OMNIA L 90 SLOWMO.HINGE X-P	0126
51LSX8M290AX000	OMNIA L 90 SLOWMO.HINGE X-P BLACK	0127

For mounting plates and fittings see page 16.

ANGLE 45°

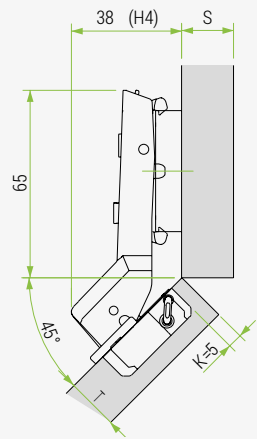

ANGLE 90°

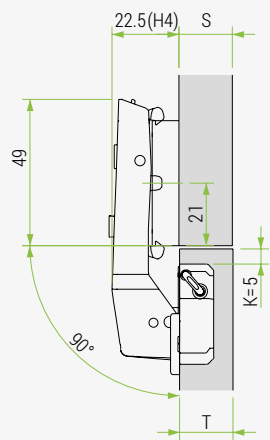

Table to determinate the minimum distance A so that a door with T thickness can open without protrusion from the cabinet and without interfering with adjacent doors.

	T=	14	15	16	17	18	19	20	21	22	23	24	25	26
K=3	A=	0.1	0.2	0.3	0.4	0.5	0.7	0.8	1	1.2	2	3.2	4.5	5.8
K=4	A=	0.1	0.2	0.3	0.4	0.5	0.6	0.8	1	1.2	1.4	2.2	3.5	4.9
K=5	A=	0.1	0.2	0.3	0.3	0.5	0.6	0.8	1	1.2	1.4	1.6	2.5	3.8
K=6	A=	0.1	0.2	0.3	0.3	0.5	0.6	0.8	1	1.2	1.4	1.6	1.9	2.8
K=7	A=	0.1	0.2	0.3	0.3	0.5	0.6	0.8	1	1.2	1.4	1.6	1.9	2.8



## Technical Specifications:

- Depth of the metal cup 11.3 mm
- Cup diameter 35 mm
- Opening 155°
- Possibility of door drilling (K) from 3 to 7 mm
- Thickness of the door (T) from 14 to 26 mm



LINEAR  
DAMPER

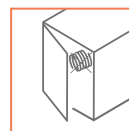

NO REBOUND



ANYCLICK  
SYSTEM



155°  
OPENING



X-PANDO EXPANDING DOWEL

A45

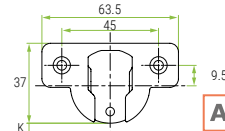

CUP HOLE DISTANCE 45X9.5 MM

A45

## CRANK 0



Code	Description	PG
51LWX8M900AX000	OMNIA L 155 C0 SLOWMO.HINGE X-P	0126
51LWX8M200AX000	OMNIA L 155 C0 SLOWMO.HINGE X-P BLACK	0127

For mounting plates and fittings  
see page 16.

## CRANK 0 For lay-on doors

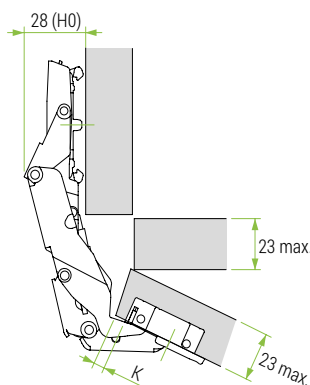
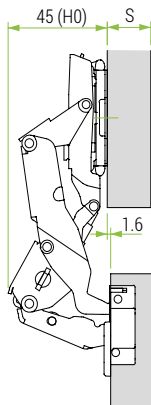
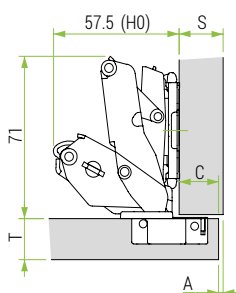

H*	Drilling distance (k)				
	3	4	5	6	7
Overlay (C) Crank 0	19			0	
	18		0		2
	17	0		2	
	16	0	2		4
	15	2		4	
	14	2	4		6
	13	4		6	
	12	4	6		
	11	6			
	10	6			

\* = with H between two values get the lower one

Table to determinate the minimum distance A so that a door with T thickness can open without protrusion from the cabinet and without interfering with adjacent doors.

T=	14	15	16	17	18	19	20	21	22	23	24	25	26
K=3 A=	0	0	0	0	0	0	0	0	0	0	0	13.7	18
K=4 A=	0	0	0	0	0	0	0	0	0	0	0	12.7	17
K=5 A=	0	0	0	0	0	0	0	0	0	0	7.4	11.7	16
K=6 A=	0	0	0	0	0	0	0	0	0	0	6.4	10.7	15
K=7 A=	0	0	0	0	0	0	0	0	0	0	5.4	9.7	14

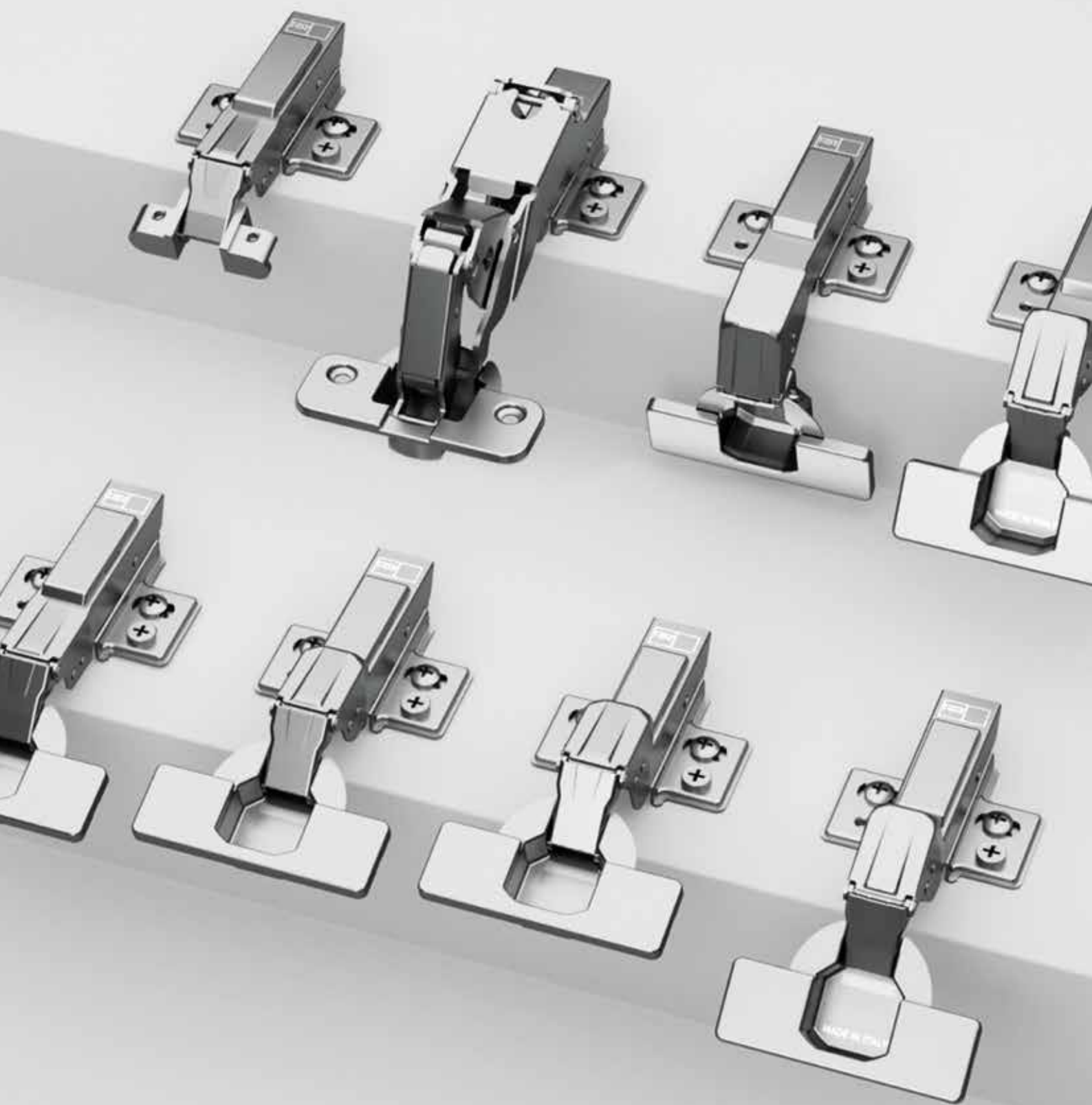

## Mounting Plates Series Omnia L

### Cruciform mounting plates



#### Metal cruciform mounting plate. Fixing by premounted Euro screws. Vertical adjustment.

Code	Description	PG
52LCEDM90200000	MOUNTING PLATE OMNIA K2 EU-ROSC.	0129
52LCEDM90400000	MOUNTING PLATE OMNIA K4 EU-ROSC.	0129

#### Metal cruciform mounting plate. Fixing by Expanding dowels Ø5mm. Vertical adjustment.

Code	Description	PG
52LCX5M90400000	MOUNTING PLATE OMNIA K4 5MM EXP.	0129

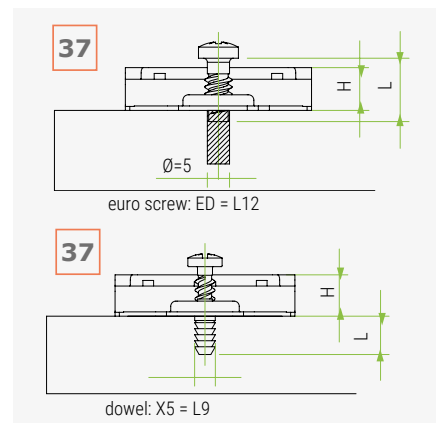
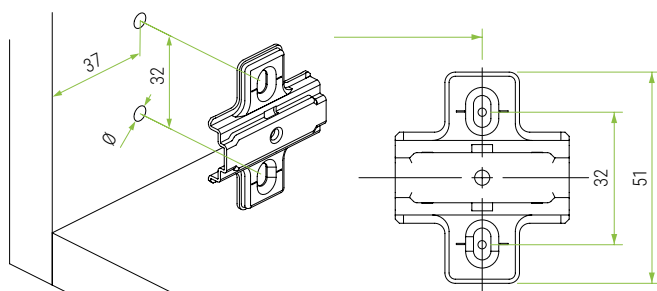

### Cruciform mounting plates with CAM



#### Metal cruciform mounting plate. Fixing by premounted Euro screws. Independent vertical adjustment with CAM.

Code	Description	PG
52RR16L902B0000	3D MOUNTING PLATE OMNIA K2 EUROSC.	0129
52RR16L202B0000	3D MOUNTING PLATE OMNIA K2 EUROSC. BLACK	0129
52RR16L904B0000	3D MOUNTING PLATE OMNIA K4 EUROSC.	0129
52RR16L204B0000	3D MOUNTING PLATE OMNIA K4 EUROSC. BLACK	0129

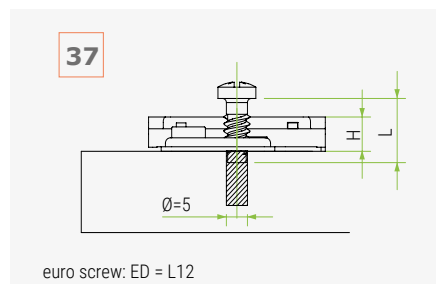
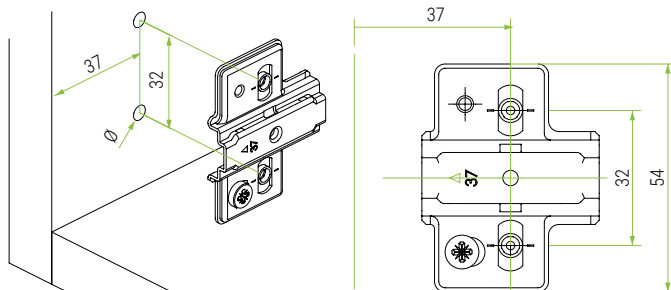

### Face frame mounting plates



#### Metal face frame mounting plate. Fixing by Selftapping screw. Vertical adjustment. (For screws see page 25)

Code	Description	PG
52LFWOM90300000	OMNIA RENOVATION MOUNTING PLATE K3	0129

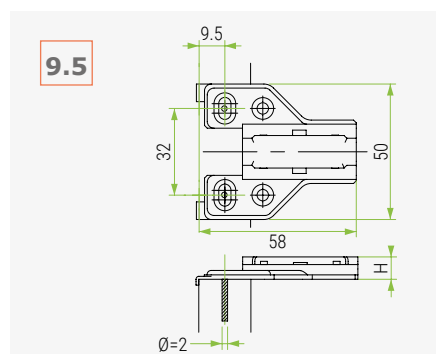
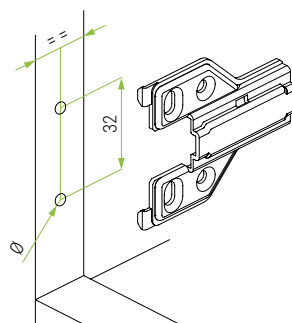

Attention: the picture shows the real product, the drawing shows drilling and mounting instruction.



## Linear mounting plates

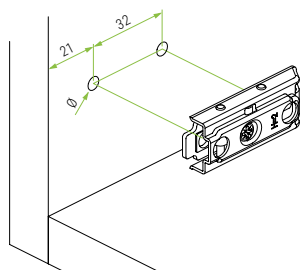

Attention: the picture shows the real product, the drawing shows drilling and mounting instruction.

### Metal linear mounting plate. Fixing by Expanding dowels Ø5mm. Independent vertical adjustment with CAM.

Code	Description	PG
52LLX5M90400000	LINEAR MOUNTING PLATE OMNIA K4 5MM EXP.	0129

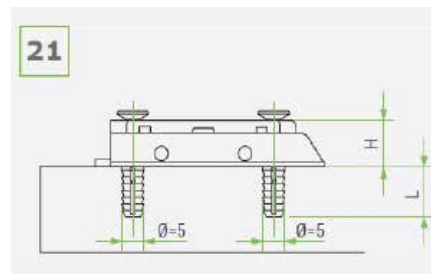
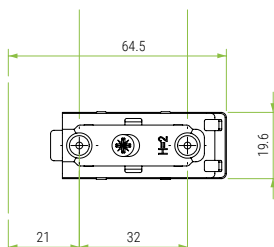

### Hinge Arm cover cap

Code	Description	PG
51LM00M90000000	OMNIA L COVER CAP HINGE ARM NICKEL PLATED	0129
51LM00M20000000	OMNIA L COVER CAP HINGE ARM BLACK PLATED	0129



### Hinge box cover cap

Code	Description	PG
51LC00M90000000	OMNIA L COVER CAP HINGE BOX NICKEL PLATED	0129
51LC00M20000000	OMNIA L COVER CAP HINGE BOX BLACK PLATED	0129



### Opening angle stopper

#### TECHNICAL SPECIFICATIONS:

- Stopper device 95°
- Application with Omnia L hinge Crank 0, 8, 15 and Angle 24°÷30°, 45°, 90°
- Made in black plastic

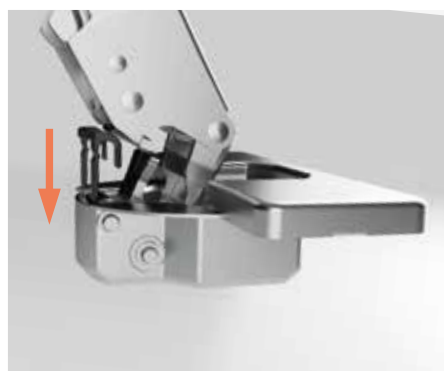

Code	Description	PG
51LA000300000000	OPENING ANGLE STOPPER	0129

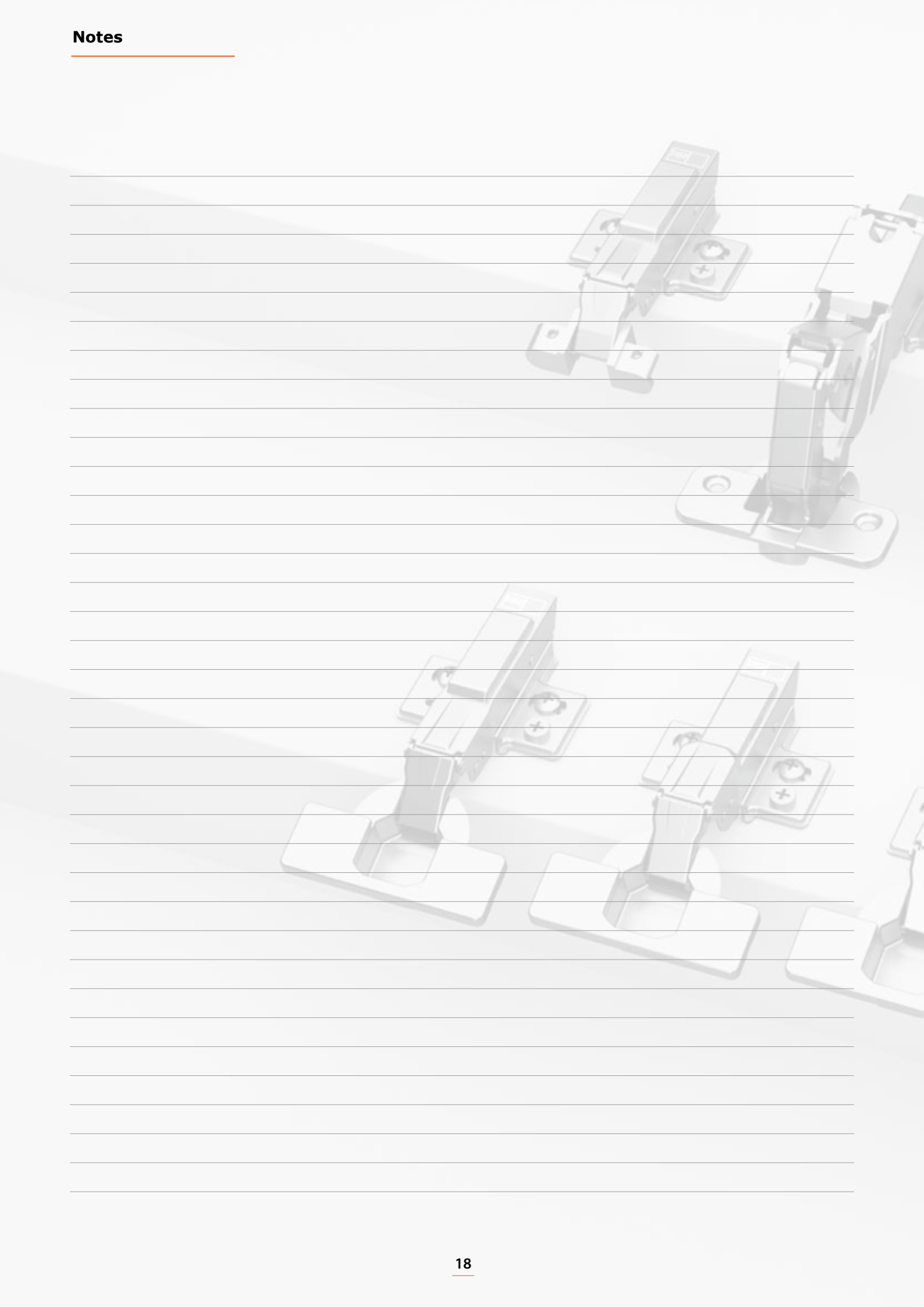

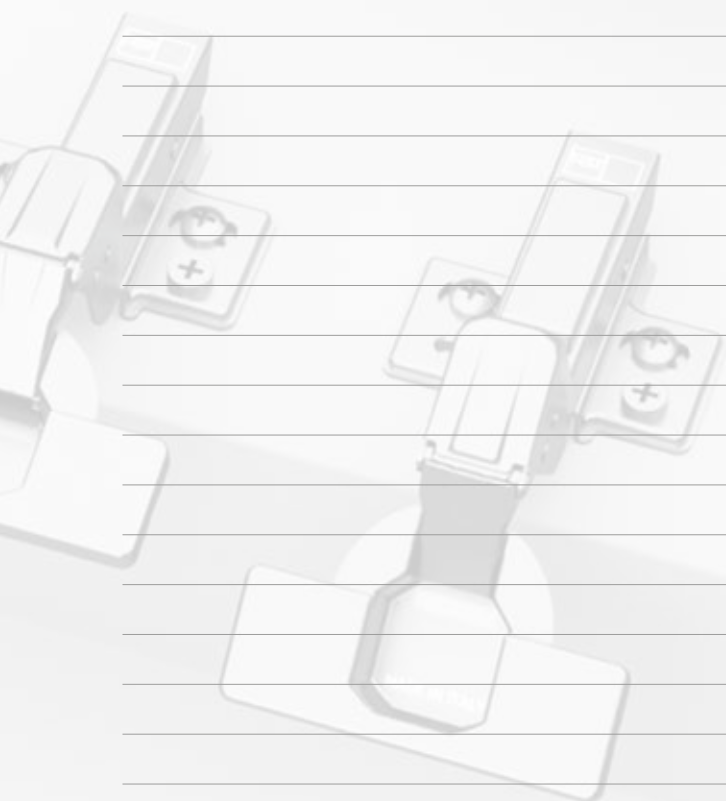
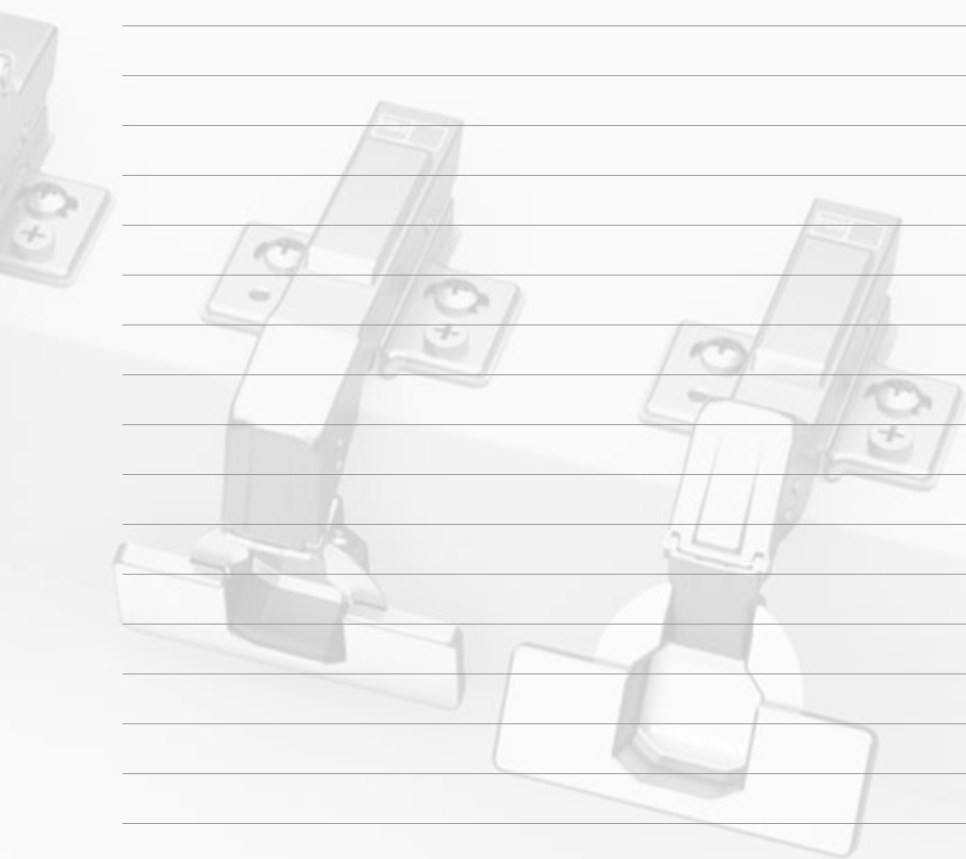





CARLO  
CASAGRANDE & CO



**Administration, sales**

Hitsaajankatu 24, 00810 Helsinki

tel. +358 (0)9 755131

[firstname.surname@carlocasagrande.fi](mailto:firstname.surname@carlocasagrande.fi)

**Orders:**

[tilaukset@carlocasagrande.fi](mailto:tilaukset@carlocasagrande.fi)

[www.carlocasagrande.fi](http://www.carlocasagrande.fi)

**Stock**

Porlamintie 5

07810 Ingermaninkylä